



FD55H-80 Drilling Unit

■ Specification

| | |
|------------------------|-------------------------------------|
| Hydraulic Pressure | 20~35 kg/cm ² |
| Drilling Capacity | φ 10(mild steel) |
| Flow Control Valve | FCC-G02-4(L) |
| Chuck Type | ER20-φ 13, JT6-φ 13 |
| Power | 0.37kw-2P,4P 0.75kw-2P,4P 220V/380V |
| Max. Revolution/Minute | 5,000rpm |
| Weigh | 38kg |
| Overall Stroke | 80mm |
| Thrust Force | 480kg(20kg/cm ²) |
| Transmission Pulley | V-SHAPE, 201J, 220J |

■ Consumption Parts

| | |
|------------------------|---|
| Spindle Bearing | a. 6004Zx2, 6003ZZx1 |
| | b. 7004x2, 7003x1 |
| Pulley Bearing | 6005ZZx1, 6205ZZx1 |
| O-Ring for Front Cover | DKB-50.62.7X1, SKY-50x1, G-65x1, P-50x1 |
| O-Ring for Piston | OSY-63x2, P-35x1 |
| O-Ring for Rear Cover | G-45x1, P-16x1, SKY-35x1, SDR-35x1 |

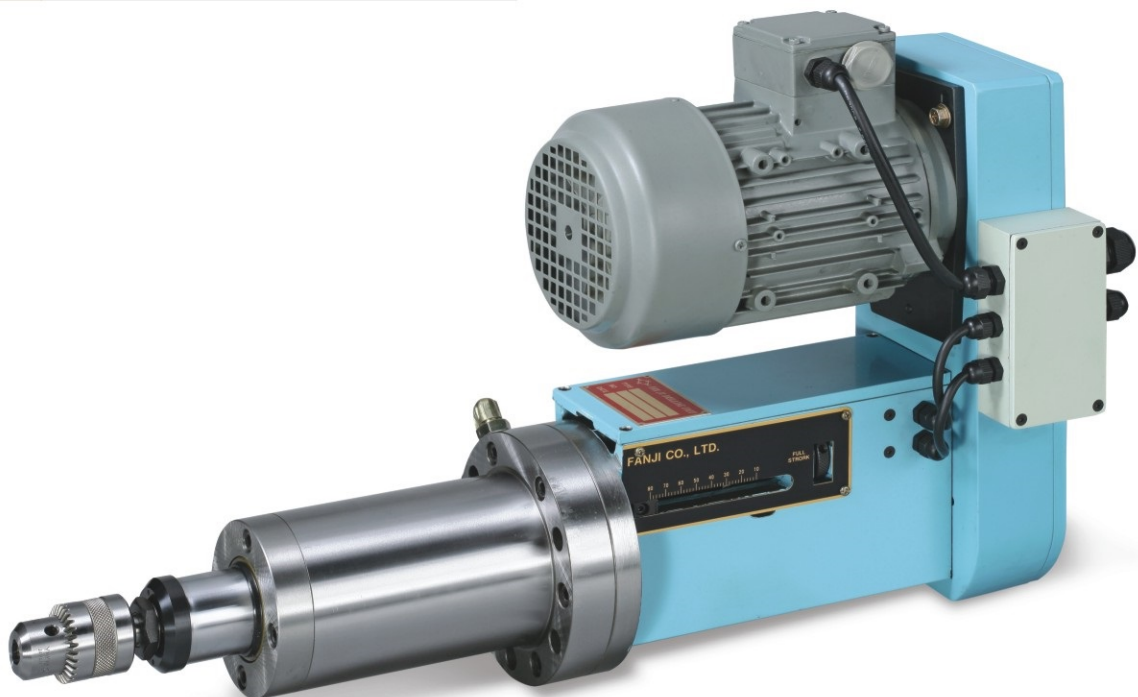



FD55H-80 Drilling Unit

Dimensions

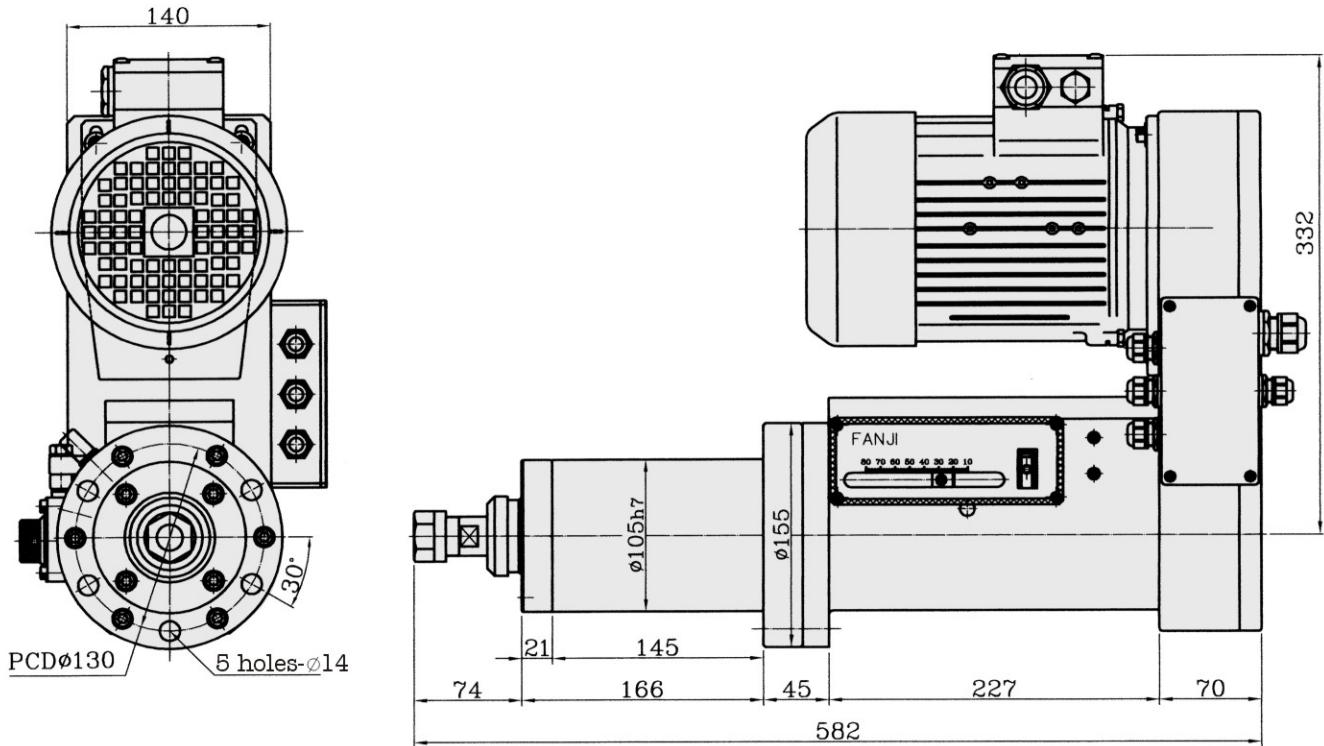

FD55H-80-KH16A

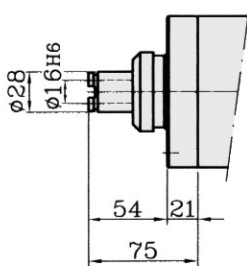

FD55H-80-ER20

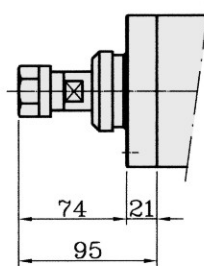

FD55H-80-JT6

